

[Required Tool : 3mm Hex Wrench]

For mounting a bike with 12mm thru axle type rear wheel such as M12 x 142mm or M12 x 148mm on Minoura trainer.

Put the adapters through the standard 9mm quick release skewer that comes in the trainer kit.

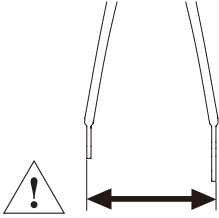

Fits the frame end width (out to out) between 162mm and 180mm.



NOTE: There are 4 types of thread sizes and 2 types of left side end shape in the 12mm Thru Axle System available in the market. Choose the appropriate shape and size to your exact bike.



for 1.0mm Pitch (Square Cut)



for 1.0mm Pitch (Tapered X-12)



for 1.0mm Pitch 2N (Double Thread)



for 1.5mm Pitch (E-Thru)



for 1.75mm Pitch (Maxle)



How To Use The Adapters

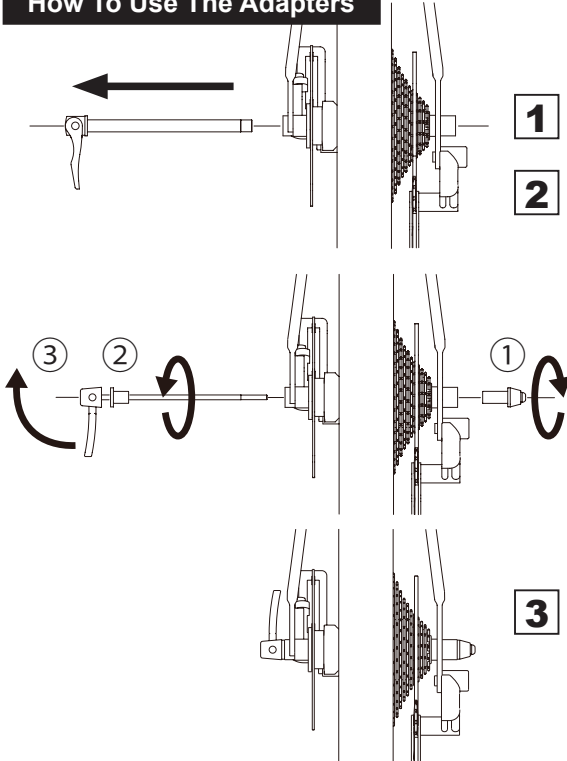

1

Remove the original 12mm thru axle.

2

- ① Screw the thread type adapter onto the right side thread of the frame, and tighten.
- ② Put the sleeve type adapter through the skewer shaft, then screw to the threaded adapter.
- ③ Turn the skewer lever to hold firmly.



Follow the standard instructions how to tighten the quick release skewer correctly.

3

Completed. Now you can mount your bike on any Minoura trainer. You should not ride on the actual road while installing this adapter.

Made in Japan

《取説# 5-50298》